

New products

Lifting stations

 **KESSEL**

# Packed with technology

for free-standing installation

The new  
*Aqualift S 100 & S 200*  
lifting stations  
for wastewater  
without sewage



 Made in Germany

Leading in drainage

*Aqualift S 100 and S 200*

# The lifting stations for private and commercial use.

for wastewater without sewage

### Space saver

Compact tanks, for use in existing pump sumps.

### Odour-tight

Tool-free cover opening with one-handed closure.

### Flexible

Two inlet connection options, left and right, for inlets up to DN 100 (inside the tank these inlets can be used as an integrated sampling chamber – norm approved), additional connection at the back for inlets up to DN 150, variable height.

### Different tank sizes

Effective pump volumes from 25 l to 100 liter.

### Powerful

Pumps with 650 W or 1300 W with multi-vane impeller.

- with 30 mm free solids passage – prevents blockages



Illustration shows: *Aqualift S 100*



Quiet operation



Plug-in ready

**Reliable with Tronic control unit**

Precise measurement of the wastewater level, intelligent pressure control via Comfort control unit with self-diagnostics system.



**One-handed closure**

Fast and easy handling of the pump and backflow preventer – no tools needed.

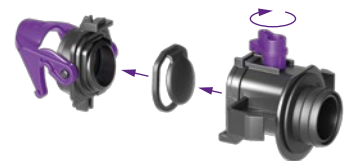

**Quiet**

Pumps are acoustically isolated to prevent structure-borne sound – reduces operational noise. Additional sound absorption mat included as standard feature.



Illustration shows: *Aqualift S 200*

**Quick to change**

As Mono and Duo system versions. Upgrade possible from existing Mono to Duo or from existing 650 W pump to 1300 W pump.



## Aqualift S 100 and S 200 for commercial use



Aqualift S 100 or S 200 as Duo system with Tronic control unit, free-standing set-up after grease separators for the disposal of kitchen wastewater.



### Saves money and space

If installed after grease separators, the Aqualift S interior inlets can be used as norm approved sampling chambers. A separate, conventional sampling chamber is therefore no longer required.

## *Aqualift S 100 and S 200* for private use



*Aqualift S 200* - free-standing set-up for complete drainage of basement wastewater, such as wastewater from washing machines, sinks or showers.



The compact dimensions of the tanks allow the *Aqualift S 100* and *Aqualift S 200* to be installed in existing sump openings.

## Lifting station **Aqualift S 100 Mono**

for free-standing installation and wastewater without sewage



Lifting station for faecal-free wastewater, free-standing set-up, preassembled for final installation on site.

- With odour-tight cover and quick-release closure for easy maintenance
- Tank made of PE, resistant to aggressive wastewater
- Including backflow preventer for the pressure pipe
- Including socket Ø 110 mm for inlet and sampling
- Pump/s with multi-vane impeller for maximum operating reliability

**Version:**

Type of system: Single station / Pump control: Float switch / Backflow preventer: integrated / Installation situation: free-standing set-up / Type of wastewater: wastewater without sewage

**General characteristics:**

Colour: black / Standard: EN 12050-2

**Dimensions:**

Length: 670 mm / Width: 530 mm / Height: 650 mm

**Tank:**

Inlet nominal size (Ø): 110 mm / Tank volume: 120 l / Pressure pipe connection (Ø): 63 mm / Pumping volume: 25 l

**Coverage features:**

Cover material: Polymer / Colour of cover: violet / Tightness: odour-tight / Locking: Quick-release closure

**Free passage:** 10 mm

**Pump:**

Type of fuse required (electrical protection): C 16 A / Max. temperature (permanent) of conveyed material: 40 °C / Connection type: Schuko (earthed contact) 2-pin / Length of mains cable for pump: 5 m / Protection class (pump): IP 68 (3 m) / Type of pump connection cable: H07RN-F 3G 1.0 mm<sup>2</sup>

**Note:**

**Pumps available as resistant versions on request:**  
individual @kessel.de

**➤ Accessories:** page 9



Illustration shows: Artikel 28 511

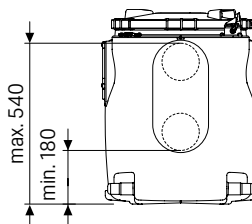
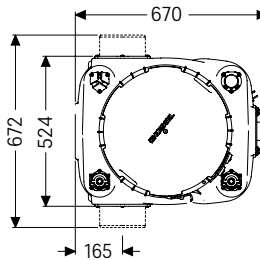
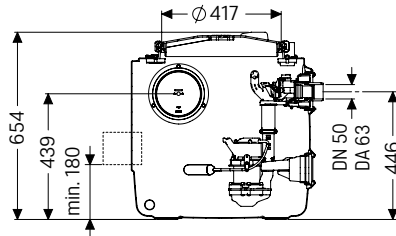
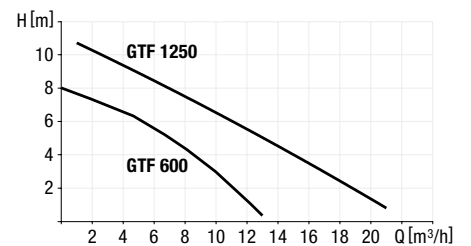

Illustration shows: Art. no. 28 511

**Mono version with one pump**

Pump GTF	Voltage	Art.-Nr.
600-S1	230 V	28 511
1250-S3	230 V	28 512

**Pumping capacity**



Pump type	Voltage	Current	Power (P1/P2)	RPM	Pumping height	Pumping capacity
GTF 600-S1	230 V ~ 50 Hz	2,9 A	0,65 kW / 0,4 kW	2750 min <sup>-1</sup>	8 m	12 m <sup>3</sup> /h
GTF 1250-S3	230 V ~ 50 Hz	5,4 A	1,3 kW / 0,8 kW	2700 min <sup>-1</sup>	11 m	20 m <sup>3</sup> /h

# Lifting station Aqualift S 100 Mono/Duo Tronic

for free-standing installation and wastewater without sewage



Lifting station for faecal-free wastewater, free-standing set-up, preassembled for final installation on site.

- With odour-tight cover and quick-release closure for easy maintenance
- Tank made of PE, resistant to aggressive wastewater
- Including backflow preventer for the pressure pipe
- Including socket Ø 110 mm for inlet and sampling
- Pump/s with multi-vane impeller for maximum operating reliability

**Version:**

Type of system: Single or twin station / Pump control: Control unit / Backflow preventer: integrated / Installation situation: free-standing set-up / Type of wastewater: wastewater without sewage

**General characteristics:**

Colour: black / Standard: EN 12050-2

**Dimensions:**

Length: 670 mm / Width: 530 mm / Height: 650 mm

**Tank:**

Inlet nominal size (Ø): 110 mm / Tank volume: 120 l / Pressure pipe connection (Ø): 63 mm / Pumping volume: 50 l

**Coverage features:**

Cover material: Polymer / Colour of cover: violet / Tightness: odour-tight / Locking: Quick-release closure

**Free passage:** 10 mm

**Pump:**

Type of fuse required (electrical protection): C 16 A / Max. temperature (permanent) of conveyed material: 40 °C / Connection type: coded plug / Length of mains cable for pump: 5 m / Protection class (pump): IP 68 (3 m) / Type of pump connection cable: H07RN-F 3G 1.0 mm<sup>2</sup>

**Comfort control unit:**

Including: Self-diagnosis system (SDS), battery buffering, multi-line digital display, log book function, USB interface, GSM interface / Potential-free contact: optional / Protection class control unit: IP 54 / Length of mains cable for control unit: 1.4 m / Type of level measurement: pneumatic / Alarm sensor: Immersion pipe

**Note:**

Pumps available as resistant versions on request: [individual@kessel.de](mailto:individual@kessel.de)

➤ **Accessories:** page 9



Illustration shows: Art. no. 28 515

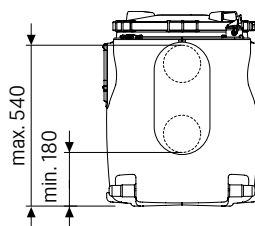
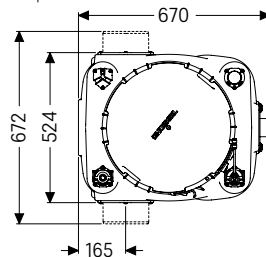
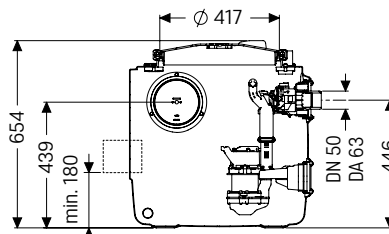

Illustration shows: Art. no. 28 513

**Mono version with one pump**

Pump GTF	Voltage	Art.-Nr.
600-S1	230 V	28 513
1250-S3	230 V	28 514

**Duo version with two pumps**

Pump GTF	Voltage	Art.-Nr.
600-S1	230 V	28 515
1250-S3	230 V	28 516

**Pumping capacity**

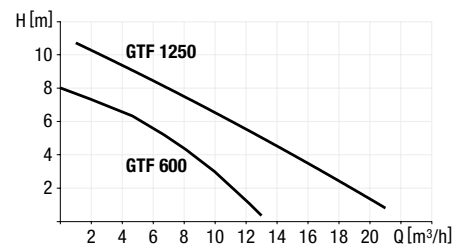

Pump type	Voltage	Current	Power (P1/P2)	RPM	Pumping height	Pumping capacity
GTF 600-S1	230 V ~ 50 Hz	2,9 A	0,65 kW / 0,4 kW	2750 min <sup>-1</sup>	8 m	12 m <sup>3</sup> /h
GTF 1250-S3	230 V ~ 50 Hz	5,4 A	1,3 kW / 0,8 kW	2700 min <sup>-1</sup>	11 m	20 m <sup>3</sup> /h



## Lifting station **Aqualift S 200 Duo Tronic** for free-standing installation and wastewater without sewage



Lifting station for faecal-free wastewater, free-standing set-up, preassembled for final installation on site.

- With odour-tight cover and quick-release closure for easy maintenance
- Tank made of PE, resistant to aggressive wastewater
- Including backflow preventer for the pressure pipe
- Including socket Ø 110 mm for inlet and sampling
- Pump/s with multi-vane impeller for maximum operating reliability

**Version:**

Type of system: Single or twin station / Pump control: Control unit / Backflow preventer: integrated / Installation situation: free-standing set-up / Type of wastewater: wastewater without sewage

**General characteristics:**

Colour: black / Standard: EN 12050-2

**Dimensions:**

Length: 670 mm / Width: 655 mm / Height: 815 mm

**Tank:**

Inlet nominal size (Ø): 110 mm / Tank volume: 220 l / Pressure pipe connection (Ø): 63 mm / Pumping volume: 100 l

**Coverage features:**

Type of cover: Cover / Cover material: Polymer / Colour of cover: violet / Tightness: odour-tight / Locking: Quick-release closure

**Free passage:** 30 mm

**Pump:**

Type of fuse required (electrical protection): C 16 A / Max. temperature (permanent) of conveyed material: 40 °C / Connection type: coded plug / Length of mains cable for pump: 5 m / Protection class (pump): IP 68 (3 m) /

Type of pump connection cable: H07RN-F 3G 1.0 mm<sup>2</sup>

**Comfort control unit:**

Including: Self-diagnosis system (SDS), battery buffering, multi-line digital display, log book function, USB interface, GSM interface / Potential-free contact: optional / Protection class control unit: IP 54 / Length of mains cable for control unit: 1.4 m / Type of level measurement: pneumatic / Alarm sensor: Immersion pipe

**Note:**

**Pumps available as resistant versions on request:**  
[individual@kessel.de](mailto:individual@kessel.de)

**➤ Accessories:** page 9



Illustration shows.: Art. no. 28 518

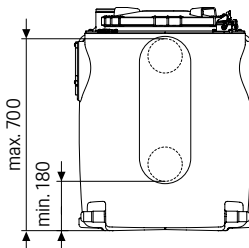
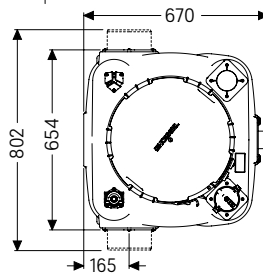
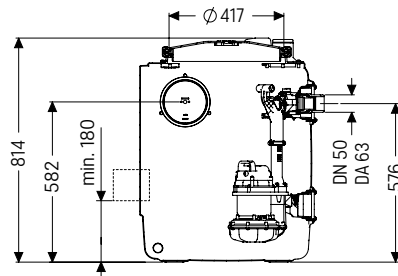
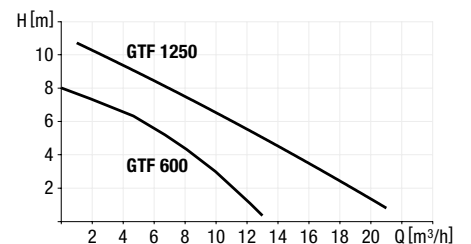

Illustration shows.: Art. no. 28 518

**Duo version with two pumps**

Pumpe GTF	Voltage	Art.-Nr.
600-S1	230 V	28 517
1250-S3	230 V	28 518

**Pumping capacity**



Pump type	Voltage	Current	Power (P1/P2)	RPM	Pumping height	Pumping capacity
GTF 600-S1	230 V ~ 50 Hz	2,9 A	0,65 kW / 0,4 kW	2750 min <sup>-1</sup>	8 m	12 m <sup>3</sup> /h
GTF 1250-S3	230 V ~ 50 Hz	5,4 A	1,3 kW / 0,8 kW	2700 min <sup>-1</sup>	11 m	20 m <sup>3</sup> /h



## Accessories

Aqualift S 100 / Aqualift S 200

### Alarm unit

		Art. no.
with optical probe	<b>Function:</b> High water / flood alarm system; for conductive / non-conductive liquids <b>Cable length:</b> 5 m (extendable up to 30 m)	20 223



### Control unit accessories

		Art. no.
Audible alarm	<b>Compatibility:</b> For all control units 230 V not for warning devices Art. no. 20 222 and 20 223 <b>Cable length:</b> 20 m	20 162



Potential-free contact	<b>Compatibility:</b> For all control units 230 V not for warning devices Art. no. 20 222 and 20 223	80 072
------------------------	---	--------



### Hole saw

		Outer pipe diameter in mm	Drill size in mm	Art. no.
Hole saw set	<b>Inclusive:</b> Saw blade holder	Ø 50	60	500 101
		Ø 75	92	
		Ø 110	121	500 100
		Ø 110	121	
		Ø 125	133	
		Ø 160	168	

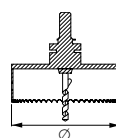

### Sealing

		Nominal pipe diameter in mm	Outer pipe diameter in mm	Art. no.
Pipe sealing gasket	<b>Drill size:</b> Ø 50: 60 mm Ø 75: 92 mm Ø 110: 121 mm Ø 160: 168 mm	DN 50	Ø 50	850 114
		DN 70	Ø 75	850 116
		DN 100	Ø 110	850 117
		DN 150	Ø 160	850 119

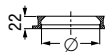

### Cable extensions

for extension to 15 m or 25 m (cable length delivered: 5 m)

	Mono version Lifting station Aqualift S 100	Duo version Lifting station Aqualift S 100 and S 200	Art. no.
Cable extension for probe (10 m)	Extension to 15 m: 1×80 889 Extension to 25 m: 2×80 889	Extension to 15 m: 1×80 889 Extension to 25 m: 2×80 889	80 889
Cable extension for pump (10 m)	Extension to 15 m: 1×80 891 Extension to 25 m: 2×80 891	Extension to 15 m: 2×80 891 Extension to 25 m: 4×80 891	80 891



### Safety

		Art. no.
Air compressor set	<b>Function:</b> For use in combination with lifting station and pumping stations with pressure control: prevents soiling, avoids the formation of condensate in the pressure hose, makes operation of systems possible with pressure hose lengths > 10 m <b>Inclusive:</b> T-piece connection, 20 m pressure hose	28 048



PE-pressure hose extension (per meter)	<b>Compatibility:</b> For Art. no. 28 048	680 071
--	---	---------

# This is KESSEL.

Since 1963, KESSEL has stood like no other company for innovative and reliable drainage technology. We have established ourselves as the impulse generator in the industry and are now a worldwide premium supplier.



Competent partner  
**since 1963**



International player  
**60+**  
**countries**



Innovative premium supplier  
**3.000+**  
**products**



Safe employer  
**550+**  
**employees**



Sustainable company  
**110+ mio. €**  
**in sales**

During the production of our products as well as their operation on-site, we keep quality assurance, environmental protection and worker's safety at the top of our list.

We also place great value in the relationship with our customer, providing consultation, installation support, commissioning and after-sales service.

One thing is certain, our innovation, quality, reliability and service is number one in the industry.

KESSEL – Leading in drainage



**Made in Germany**





KESSEL Headquarters Lenting, Germany

# Leading in drainage.

No matter whether the task involves discharging water, wastewater treatment or backwater protection: if the best solution is required, there is no option but KESSEL.

**Backwater protection**

**Pump technology**

**Separator technology**

**Drainage technology**



For further  
information visit  
[www.kessel.com](http://www.kessel.com)



For further  
information visit

[www.kessel.com](http://www.kessel.com)



Rights reserved for technical changes.

**KESSEL AG**

Bahnhofstraße 31 • 85101 Lenting • Germany

[www.kessel.com](http://www.kessel.com)