

# Parking deck drains

## The load bearers made of *Ecoguss*.

An innovation that sets standards: For parking deck drains we use our *Ecoguss* high-tech composite, which combines the specific advantages of polymer and metal and is an economic and easy to install alternative to drains made of grey cast iron. At the same time, parking deck drains made of *Ecoguss* offer large advantages with regard to hygiene as well as fire protection and sound insulation and are extremely load resistant and break-proof. There are therefore ideally suitable for use in underground car parks, multi-storey car parks and industrial buildings.

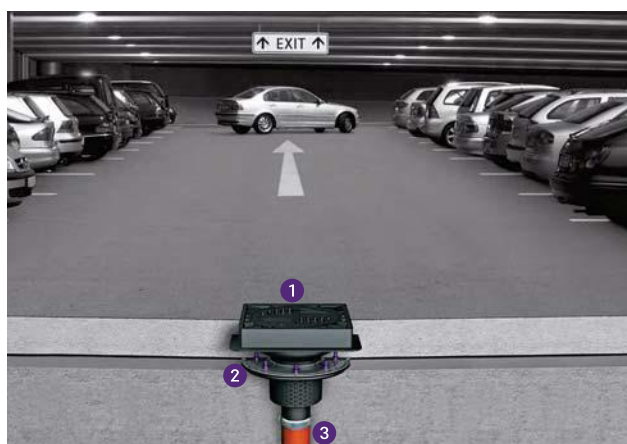

1 Upper section 2 Sealing flange 3 Connection to SML-pipe

### Break-proof & load resistant

Our parking deck drains made of *Ecoguss* are break-proof and fulfil the requirements for load class B 125. They can therefore be loaded with up to 12.5 tonnes and can be easily driven on by cars or pick-up trucks.

### Highest fire protection standards

In case of fire, water outlets constitute a risk, as the fire can pass through the discharge pipes and spread to other parts of the building. Our drains can be equipped with the *Fire-Kit* fire and smoke protection insert or the *Quick-Fit* passage seal with integrated fire protection. As soon as fire penetrates the drain body, the fire protection compound inside it swells automatically and seals the pipe socket against flames and smoke. Not only the *Fire-Kit* but also the *Quick-Fit* fulfil the highest fire rating R 120.

Resistance, convenience, cleanliness – all these are offered by *Ecoguss* - our high-tech composite.

➤ Floor/roof drain *Ecoguss*: Page 226

### Parking deck drain *Ecoguss*

with pressure sealing flange in stainless steel AISI 304



Made in *Ecoguss*

Vertical outlet, for connection to SML-pipe according to EN 877, with sludge trap. Drainage capacity 4.5 l/sec flow rate. Installation area 300×300 mm

With pressure sealing flange in stainless steel AISI 304, with square upper section in *Ecoguss* with connection flange 247×247 mm

**Cover:**

Round slotted cover Ø 234 mm, class B 125 (12.5 to), with *Lock & Lift System*

**Note:**

Core drilling only Ø 160 mm with *Quick-Fit*

➤ **Accessories:** *Multistop* Art. no. 48 500 see page 285

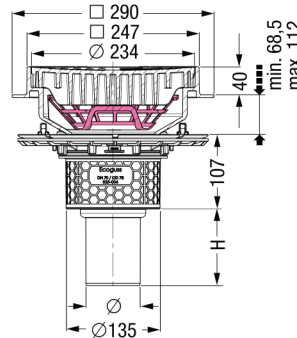

Outer diameter Ø (mm)	Height H in mm	Height H1 in mm	Art. no.
System 125			
Ø 78	110	-	48 878.01
Ø 110	110	-	48 811.01

### Parking deck drain *Ecoguss*

square or round



Made in *Ecoguss*

Vertical outlet, for connection to SML-pipe according to EN 877, with sludge trap. Drainage capacity 4.5 l/sec flow rate. Installation area 300×300 mm

With square (247×247 mm) or round (Ø 247 mm) upper section in *Ecoguss* with connection flange

**Cover:**

Round slotted cover Ø 234 mm, class B 125 (12.5 to), with *Lock & Lift System*

**Note:** Can be used as single piece pipe connection drain!

➤ **Accessories:** *Multistop* Art. no. 48 500 see page 285



Illustration shows Art. no. 48 502

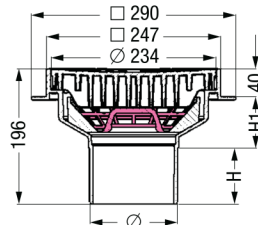

Illustration shows Art. no. 48 501, 48 502

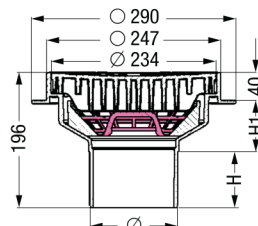

Illustration shows Art. no. 48 503, 48 504

Outer diameter Ø (mm)	Height H in mm	Height H1 in mm	Art. no.
System 100 (SML-pipe) with square upper section			
Ø 110	77	79	48 501
System 125 (plastic pipe) with square upper section			
Ø 125	83	73	48 502
System 100 (SML-pipe) with round upper section			
Ø 110	77	79	48 503
System 125 (plastic pipe) with round upper section			
Ø 125	83	73	48 504

## Modular system 100 / 125

Parking deck drains *Ecoguss*

System 100

System 125

### Upper section with connection flange

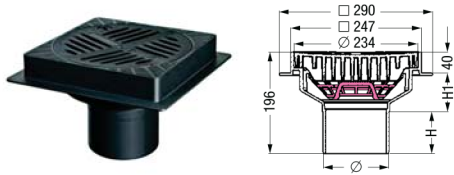

#### with square upper section

Material: *Ecoguss*

Class: B 125

Upper section: 247×247 mm

Slotted cover: Ø 234 mm

Drainage capacity: 4.5 l/sec flow rate

Inclusive: *Lock & Lift* System, sludge trap

Compatibility: Ø 110 not in combination with drain body *Ecoguss*

Note: Can be used as single piece pipe connection drain!

System 100 (SML-pipe)	Ø 110	H 77 mm	H1 83 mm	Art. no. <b>48 501</b>
System 125 (plastic pipe)	Ø 125	H 79 mm	H1 73 mm	Art. no. <b>48 502</b>

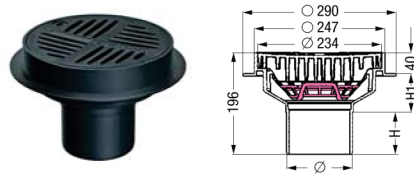

#### with round upper section

Material: *Ecoguss*

Class: B 125

Upper section: Ø 247 mm

Slotted cover: Ø 234 mm

Drainage capacity: 4.5 l/sec flow rate

Inclusive: *Lock & Lift* System, sludge trap

Compatibility: Ø 110 not in combination with drain body *Ecoguss*

Note: Can be used as single piece pipe connection drain!

System 100 (SML-pipe)	Ø 110	H 77 mm	H1 83 mm	Art. no. <b>48 503</b>
System 125 (plastic pipe)	Ø 125	H 79 mm	H1 73 mm	Art. no. <b>48 504</b>

### Accessories



#### Extension section

Material: PP

Inclusive: Lip seal

without lateral inlet Art. no. **48 987**

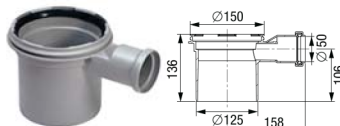

#### Extension section

Material: PP

Inclusive: Lip seal

with lateral inlet Ø 50 Art. no. **48 989**



#### Multistop

Odour, foam, rodent and insect stop

Art. no. **48 500**

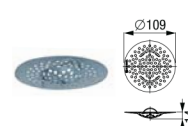

#### Hair filter

Material: Polymer

Art. no. **48 700**



#### Odour trap

Sealing water height 50 mm acc. to norm

Art. no. **48 600**



#### Fire-Kit Fire protection insert

Only for *Ecoguss* drains with vertical outlet and odour trap  
Art. no. **27 169**

Certification no.: Z-19.17-1719

Ø 58/78/83	Art. no. <b>48 099</b>
Ø 110	Art. no. <b>48 100</b>



#### Bell-shaped odour trap insert

Material: PP  
sealing water height 50 mm

Art. no. **27 169**



#### Quick-Fit the passage seal

The all-round seal for core drillings for *Ecoguss* drain body, vertical outlet (only use Art. no. 48 990 in combination with *Fire-Kit* fire protection insert)

\*Certification no.: Z-19.17-1719

without fire protection	Art. no. <b>48 991</b>
with fire protection*	Art. no. <b>48 990</b>



#### Insulating body

fits all *Ecoguss* drain bodies with vertical outlet

Art. no. **48 952**

### Drain body *Ecoguss*

without odour trap



#### with pressure sealing flange

Version: High temperature resistant

Sealing water height: 50 mm

Drainage capacity: 4.5 l/sec flow rate

Ø 78 H 110 mm Art. no. **48 879**

Ø 83 H 110 mm Art. no. **48 889**

Ø 110 H 110 mm Art. no. **48 812**

# Yard drains

The load resistant drain for outdoor use.

We supply yard drains not only made of polymer but also made of *Ecoguss*, our high-tech composite, which combines the specific advantages of polymer and metal. They are available in different load classes and can be driven on by vehicles weighing up to 12.5 tonnes.



- 1 System 400 drain body
- 2 Height-adjustable upper section with cover
- 3 Sludge basket



- 1 Upper section and cover
- 2 Concrete
- 3 Sludge basket
- 4 Locking system

## Break-proof & load resistant

Our yard drains are absolutely break-proof and fulfil different load classes up to D. They can therefore be loaded with up to 40 tonnes and can be easily driven on by cars and/or trucks.

## Flexible installation options

Thanks to their unique rotatable, tiltable and up to 350 mm height-adjustable telescopic upper sections, our yard drains can be adjusted exactly to the required ground level.

## Yard drain *Ecoguss*

pipe connection drain - square / round

Made in *Ecoguss*

Vertical outlet, with sludge trap.  
Drainage capacity 4.5 l/sec flow rate

With square (247×247 mm) or round (Ø 247 mm) upper section in *Ecoguss*

**Cover:**

Round slotted cover Ø 235 mm, class B 125 (12.5 to), with *Lock & Lift System*

➤ **Accessories:** *Multistop* Art. no. 48 500 see page 285



Illustration shows Art. no. 67 110B

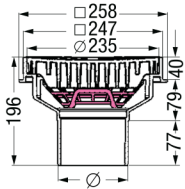

Illustration shows Art. no. 67 110B

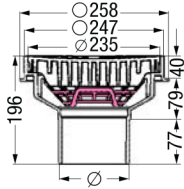

Illustration shows Art. no. 67 111B

System 100



Outer diameter Ø (mm) Art. no.

With square support rim

Ø 110 67 110B

with round support rim

Ø 110 67 111B

## Yard drain *Alrondo*

vertical outlet

Made of polymer

Vertical outlet, with integrated odour trap.  
Drainage capacity 1.6 l/sec flow rate

Cover plate 200×200 mm

**Cover:**

Round slotted cover Ø 140 mm, screwed, can be driven over by vehicles of up to 1 ton



System 100



Outer diameter Ø (mm) Art. no.

Ø 110 37 287 S

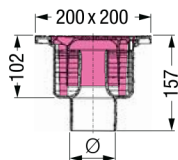

## Yard drain *Ecoguss* 200

Lateral or vertical outlet

Upper section made of *Ecoguss*,  
drain body made of polymer

With sludge trap.

Drainage capacity 4.5 l/sec flow rate

Upper section made of *Ecoguss*,  
with square support rim

**Cover:**

Round slotted cover, class B 125 (12.5 to),  
with *Lack & Lift* System



Illustration shows Art. no. 67 923B

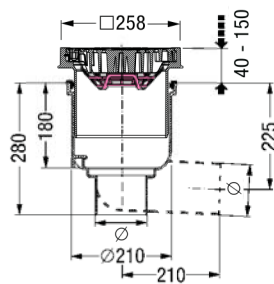

Illustration shows  
Art. no. 67 922B, 67 923B

System 200



Outer diameter Ø (mm) Art. no.

Lateral outlet

Ø 110 67 923B

Vertical outlet

Ø 110 67 922B

## Yard drain System 200

Lateral or vertical outlet

Made of polymer

With lip seal and protective cover  
for use during construction.

Drainage capacity 4.5 l/sec flow rate

drain body made of polymer,  
upper section with support rim

**Cover:**

Slotted cover, class A 15



Illustration shows Art. no. 67 020.30

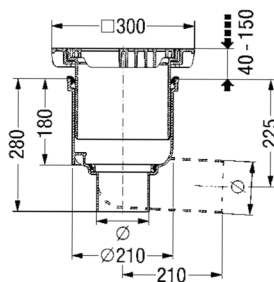

Illustration shows  
Art. no. 67 020.30, 67 060.30

System 200



Outer diameter Ø (mm) Art. no.

Lateral outlet

Ø 110 67 020.30

Vertical outlet

Ø 110 67 060.30

## Modular system 200

Yard drains

System 200

### Upper section

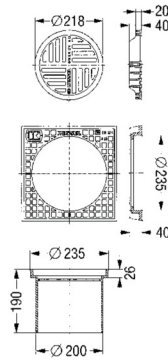
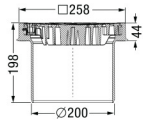

### in *Ecoguss*

**Version contains:** Upper section with support rim 250 × 250 mm, height adjustable

**Cover:** Round slotted cover Ø 235 mm in *Ecoguss*, class B 125, *Lock & Lift* System, height adjustable from 40 - 150 mm

Art. no. 67 985

### in polymer, consists of ...

**Slotted cover:** Ø 218 mm, class A 15 / L 15 (1.5 to.)

Art. no. 27 173

**Support rim:** 250 × 250 mm, class A 15 / L 15 (1.5 to.)

Art. no. 27 180

**Upper section:** Height adjustable from 40 - 150 mm

Art. no. 67 400

### Accessories

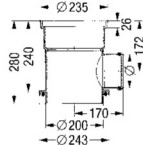
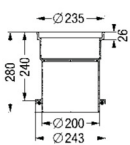

### Extension section

**Material:** Polymer

**Installation height:** 240 mm

without lateral inlet Art. no. 67 500

### Extension section

**Material:** Polymer

**Installation height:** 240 mm

with lateral inlet Art. no. 67 600

### Sludge basket

**Material:** PE-HD

Art. no. 67 300

### Lip seal

Art. no. 27 140

### Lip seal

Non-slip mounting

Art. no. 27 141

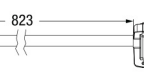
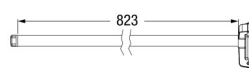
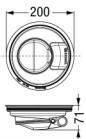
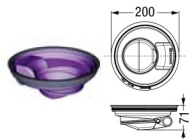

### Multistop 200

Odour, foam, rodent and insect stop, for Art. no. 67 985, 67 923B, 67922B

Art. no. 48 520

### Bell-shaped odour trap insert

**Material:** PP, removable

**sealing water height:**

H = 70 mm (Art. no. 27 170)

H = 100 mm (Art. no. 27 171)

H 70 mm

Art. no. 27 170

H 100 mm

Art. no. 27 171

### Lifting mechanism

For removing odour trap in case of deeper installation.

**Compatibility:** Art. no. 27 171, 67 960, 67 970

Art. no. 850 144

### Locking and removal key

For *Ecoguss* drain covers with *Lock & Lift* System

Art. no. 67 007

### Drain body in polymer

without odour trap

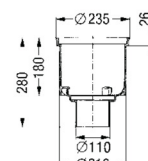
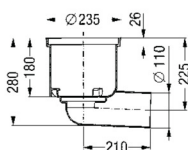

### Lateral outlet 2.5°

**Drainage capacity:** 4.5 l/sec flow rate

Ø 110 Art. no. 67 000

### Vertical outlet

**Drainage capacity:** 4.5 l/sec flow rate

Ø 110 Art. no. 67 040

## Yard drain System 400

for higher load classes

System 400



Made in polyethylene

Lateral outlet 2.5°, with sludge trap.

Water-tight, resistant to aggressive wastewater. With fuel-resistant gaskets.

Drainage capacity 4.5 l/sec flow rate.

Installation depth (D) from 380 – 510 mm.

Installation area 585 × 535 mm



Outer diameter Ø (mm) Art. no.

Ø 110	851 100A
Ø 110	851 100B
Ø 110	851 100D
Ø 160	851 150A
Ø 160	851 150B
Ø 160	851 150D

Upper section with slotted cover, class A (1.5 to.) made of polymer, 400 × 400 mm, class B (12.5 to.) in cast iron according to EN 124, 400 × 400 mm and class D (40 to.) in cast iron according to EN 124, 450 × 450 mm for continuous height and level adjustment.

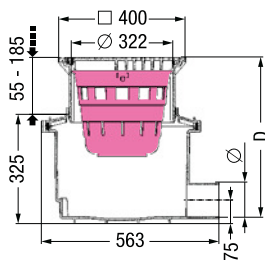



## Yard drain System 400

for higher load classes

Made in polyethylene

Lateral outlet 2.5°, with odour trap and sludge trap.

Water-tight, resistant to aggressive wastewater.

With fuel-resistant gaskets.

Drainage capacity 4.5 l/sec flow rate.

Installation depth (D) from 730 – 1080 mm.

Installation area 585 × 535 mm

Upper section with slotted cover, class A (1.5 to.) made of polymer, 400 × 400 mm, class B (12.5 to.) in cast iron according to EN 124, 400 × 400 mm and class D (40 to.) in cast iron according to EN 124, 450 × 450 mm for continuous height and level adjustment.

System 400



Outer diameter Ø (mm) Art. no.

Ø 110	851 102A
Ø 110	851 102B
Ø 110	851 102D
Ø 160	851 152A
Ø 160	851 152B
Ø 160	851 152D

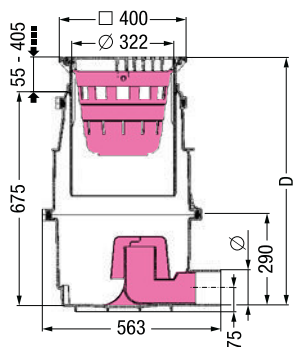

## Modular system 400

System 400

Yard drains

### Covers



#### Cover plate in polymer

Class: A (1.5 to.)

Art. no. 850 132

#### Cover plate in cast iron

Class: B (12.5 to.)

Art. no. 850 131

#### Cover plate in cast iron

Class: D (40 to.)

Compatibility: Art. no. 850 121

Art. no. 850 136

### Upper section



#### Class A, B

Continuously height adjustable, with clamping ring

Art. no. 850 120

### Accessories



#### Extension section

Material: Polyethylene

Art. no. 850 101

#### Connecting wedges

4 pieces

Art. no. 850 111

#### Transition section 450

Art. no. 850 102

#### Transition section 360

Art. no. 850 103



#### Odour traps

\*Compatibility: Art. no. 850 009, 850 010

Ø 110 mm Art. no. 850 141

Ø 160 mm\* Art. no. 850 142

#### Pressure sealing flange

Compatibility: Upper section

Art. no. 83 021

#### Gaskets for pipe conduits

Ø 50 mm Art. no. 850 114

Ø 75 mm Art. no. 850 116

Ø 110 mm Art. no. 850 117

Ø 125 mm Art. no. 850 118

Ø 160 mm Art. no. 850 119

### Drain body in polyethylene

without odour trap

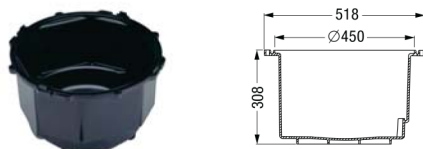

#### Closed

Art. no. 850 008

System 400



**Slotted cover in polymer**

Class: A (1.5 to.)

Art. no. 850 134



**Slotted cover in cast iron**

Class: B (12.5 to.)

Art. no. 850 135

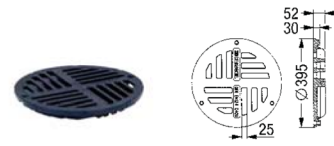

**Slotted cover in cast iron**

Class: D (40 to.)

Compatibility: Art. no. 850 121

Art. no. 850 137

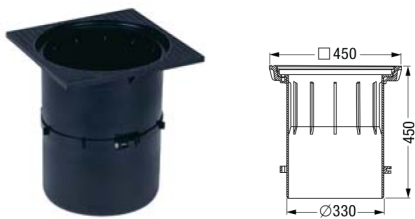

**Class D**

Continuously height adjustable, with clamping ring

Art. no. 850 121



**Sludge trap**

Material: Polymer

Art. no. 850 115



**Profiled gasket 450**

Art. no. 850 113



**Profiled gasket 360**

Art. no. 850 112

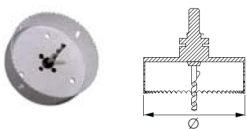

**Hole saw**

for drilling lateral surfaces for inlets and outlets  $\varnothing$  50, 75, 110, 125 and 160 (Saw blade holder  $\varnothing$  = 190 mm)

Art. no. 50 100



**Elastomer waterproof membrane**

Material: NK/SBR

Art. no. 83 022

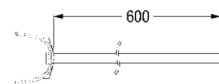

**Lifting mechanism**

For removing odour trap

Art. no. 850 143

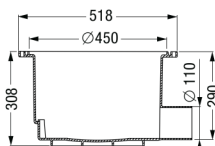

**with outlet**

$\varnothing$  110 mm Art. no. 850 009  
 $\varnothing$  160 mm Art. no. 850 010