



Starch separators

Starch removal from commercial wastewater (from potato peeling wastewater)

Starch separator *EasyStarch* free / ground

The strong solution for starchy wastewater.

Strong-acting against starch: *EasyStarch*. Starch occurs during the processing of potatoes, rice and grain. The starch separator *EasyStarch* is used to prevent deposits, encrustations and blockages in the drainage pipes.

The *EasyStarch* is available for free-standing installation and underground installation. Please get in touch with us – we will be happy to advise you and develop an individual solution for your specific requirements.

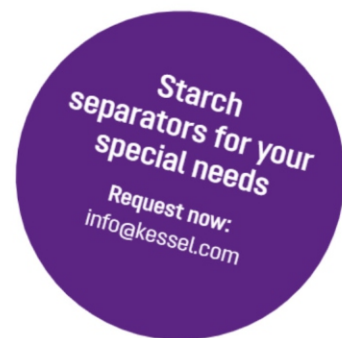

1 Starch separator 2 Sampling chamber 3 Lifting station

Polymer

Polymer starch separators are an advantageous alternative to metal solutions as they do not need to be refurbished, even after many years.

The polyethylene material used is particularly durable. In addition to the statutory provision, we provide a 20-year warranty with regard to the leak tightness, fitness for purpose and structural safety of tanks and upper sections.



What happens inside a starch separator?

Starch settles to the base of a starch separator due to it being heavier than water. However, foam formation can be expected inside the separator which needs to be reduced by an internal foam reduction spray system.

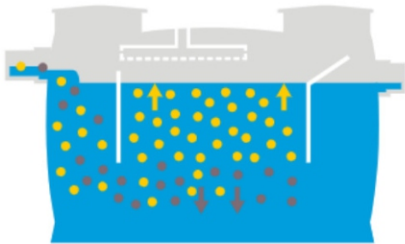

Wastewater discharge

Wastewater from the potato peeling machine is discharged into the starch separator via a flow calming section (calming section at least 1 m)

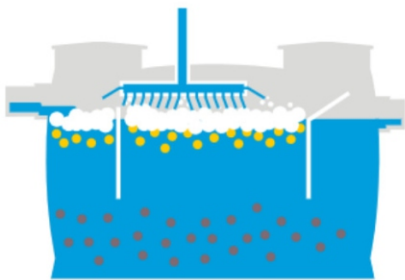

Formation of foam layer

Starch foam is reduced by a water spray system. Where possible, the water connection of the spray system is activated by switching on the potato peeler machine.

Option: Additional device for water spray system (#ZESA40)

Submersible pump operates the spray system with water from the clean water zone of the starch separator.

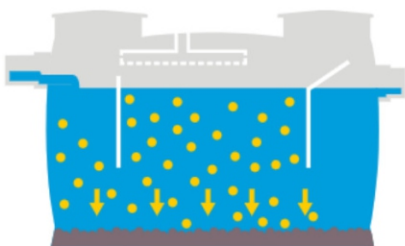

Formation of starch layer

Spraying the starch foam causes the starch to settle to the bottom of the tank. The treated wastewater flows out of the starch separator via gravity.



Starch separators *EasyStarch* free Standard NS 0.5 – 3

for free-standing installation



EN 1825

Tank

Manufactured from virgin, non-recycled polyethylene, for free standing installation in frost protected areas, foam suppressing rinsing rod system, sloped interior base improves cleaning and reduces disposal time, inlet flow calming system and outlet flow regulation device, slanted twin access covers with quick release odour tight snap closures, integrated fork lift grips at base of separator, 100 % corrosion free polyethylene body construction (20 year warranty).

Disposal System

Standard version requires disposal truck with vacuum system for separator disposal.

Delivery: System completely assembled.

Recommended accessory: ZESA40

ZESA40 is a water supply system for the foam suppressing system consisting of a pump (Type GTF 500), suction hose (DN32/PN6) and high-pressure pipe DN32/PN6 (DA = 40 × 2.3 mm), control unit

➤ **Accessories:** Sampling chamber page 374

➤ **Technical note:** page 340



NS	Art. no.
Without accessories	
NS 0.5	94 200.01
NS 1	94 201.01
NS 2	94 202.01
NS 3	94 203.01

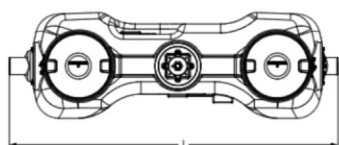
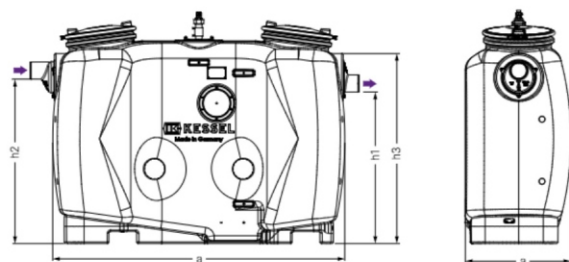

NS	Ø (mm)	a (mm)	Installation dimension l × b (mm)	h1 (mm)	h2 (mm)	h3 (mm)	Weight (kg)	Total (l)
0.5	110	1500	1735 × 680	985	1055	1435	84	600
1	110	1880	2115 × 680	985	1055	1435	97	800
2	110	1910	2145 × 940	1185	1255	1655	145	1350
3	110	2590	2820 × 940	1185	1255	1655	191	1900

Ø = Outer diameter